

INTRODUCTION

Congratulations on your purchase of the Pet Fountain. This unique bubbling pet fountain is ideal for cats and dogs of all sizes. The continuous bubbling stream attracts your pet, encouraging them to drink more water throughout the day for improved health.

⚠ WARNING: Do not leave this appliance unattended and always unplug when not in use. Do not put tension on the power supply cable. Always ensure that the power supply cable has sufficient free length. Never operate this appliance if it has a damaged power supply cable or plug. Do not allow the power supply cable to hang or be in an area where it may be tripped over or accidentally pulled. Do not disassemble. If the supply cable is damaged, the appliance should be thrown away.

NOTE: The power supply voltage required for this appliance is 120V~ 60Hz. Do not activate the pump without being fully submerged in water or if it is outside of the fountain. If it is not submerged in water before the power is started, the pump will suck in air and not function properly. It will take 20-30 seconds before the pump is activated.

Please read all instructions and warnings on this sheet prior to using your Pet Fountain. Keep this instruction sheet as it contains important information for future reference.

ASSEMBLY



Lift and remove dome.

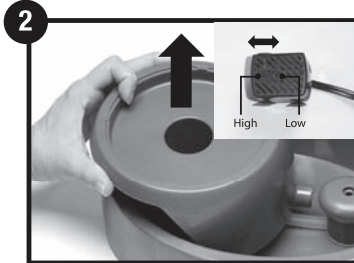

Lift and remove dome base. Slide the switch on the pump to adjust water flow.



Insert the water pump tube into the rubber hose. Make sure it is all the way in.

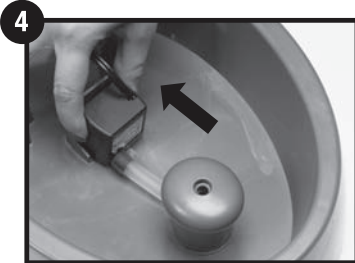

Press the suction cups on the back of the pump onto the internal wall. Make sure that the power cord is positioned as pictured above. This will ensure that the water intake point on the pump is in the correct place.

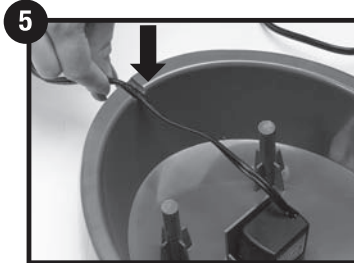

Rest the power cord in the indented area on the back of the base. Fill the base with water to at least the minimum fill line level. The pump must be submerged to function.

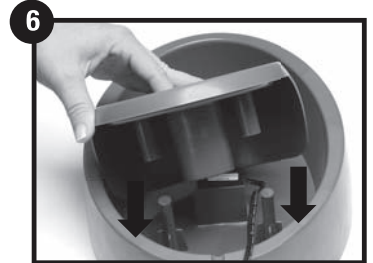

Align the bottom posts with the tubes on the dome base and attach the base.

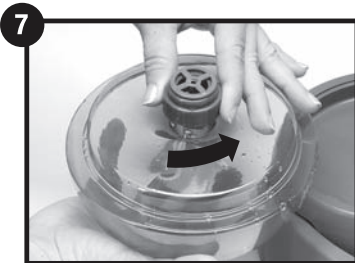

Rotate the dome cap counterclockwise and remove.

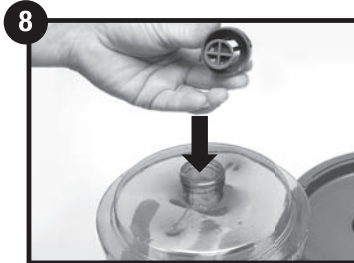

Fill the dome with water and replace the cap.



Place the dome on the base in the designated area. Plug into a standard electrical outlet. Keep the base and dome filled for optimum function.

⚠ WARNING: Never operate the fountain without water. If the water becomes too low, use can be dangerous. Be sure to keep the water volume above the minimum fill line and unplug the fountain if the water volume falls below that line.

CARING FOR YOUR PET FOUNTAIN

Clean your Pet Fountain with water and a damp cloth.