

# OPERATING INSTRUCTIONS

## RACE CAR DIAGRAM

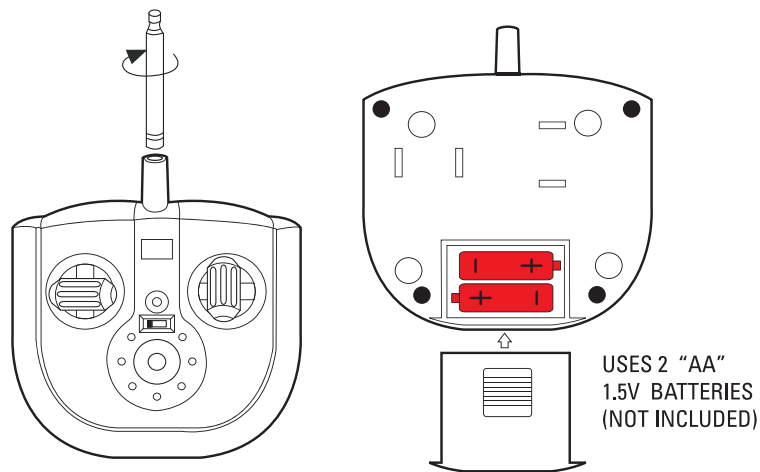
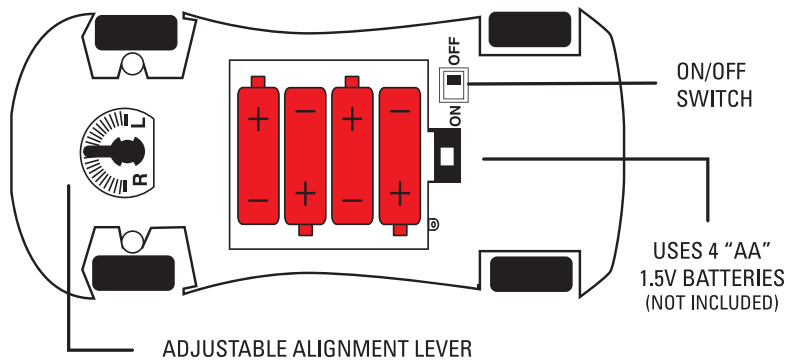

Operation requires 4 "AA" 1.5V alkaline batteries for car and 2 "AA" 1.5V alkaline batteries for remote control. (NOT INCLUDED)

- 1) Carefully remove items from package.
- 2) Locate the battery compartment on the back of each item.
- 3) Switch both car and remote buttons to "ON" position.
- 4) Adjust lever on bottom of car to left or right direction.
- 5) Available in two frequencies to race against each other.

### BATTERY WARNING:

- Do not mix alkaline, standard (carbon-zinc) and rechargeable batteries (nickel hydride).
- Do not mix old and new batteries.
- Non-rechargeable batteries are not to be recharged.
- Rechargeable batteries are to be removed from the item before being charged.
- Rechargeable batteries are only to be charged under adult supervision.
- Exhausted batteries are to be removed.
- The supply terminals are not to be short-circuited.
- Only batteries of the same or equivalent type as recommended are to be used.
- Batteries are to be inserted with the correct polarity (see above diagrams).

**KEEP THIS PACKAGE FOR REFERENCE AS IT CONTAINS IMPORTANT INFORMATION.**